

APPLICABLE RECOMMENDED LAYOUT  
(THICKNESS:0.3±0.05)

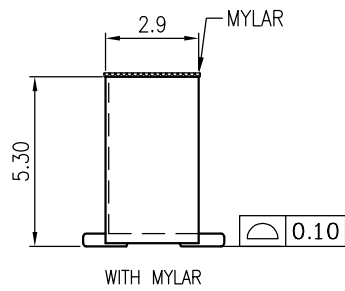
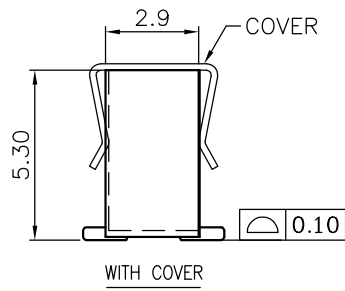
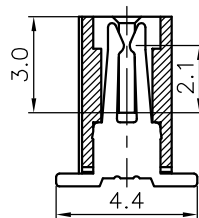

NOTES:

- MATERIAL:
  - HOUSING: THERMOPLASTIC, HIGH TEMP.,UL94V-0
  - CONTACT: COPPER ALLOY
- FINISH: CONTACT:
 

UNDERPLATING: 50~100u" NICKEL OVERALL.

FINISH:SEE ORDER INFORMATION.
- REFLOW SOLDER CAPABLE TO 260°C PER ACES SPEC.
- SPEC. PLS. REFER TO PS-50661-XXXXX-XXX
- PACKAGE PLS. REFER TO 50661-XXXXX-XX-TRP
- PART NUMBER

P/N LEGEND

50661-XXX X X -XXX

NO OF CKT

XXX	Housing MAT.	Housing Color.	Halogen Free
001	HF PLASTIC	BLACK	HF

PLATING  
1:GOLD FLASH OVERALL(LEAD FREE)  
N: MATT TIN (LEAD FREE)

PACKING  
0:TAPE & REEL  
1:TUBE

4:TAPE & REEL WITH MYLAR  
5:TUBE WITH MYLAR  
7:TAPE & REEL WITH COVER  
8:TUBE WITH COVER

CKT	A	B	C	E	M/SIZE	CKT	A	B	C	E	M/SIZE
3	2.0	4.1	5.0	4.0	3.0	16	15.0	17.1	18.0	10.0	6.0
4	3.0	5.1	6.0	4.0		17	16.0	18.1	19.0	10.0	
5	4.0	6.1	7.0	4.0		18	17.0	19.1	20.0	10.0	
6	5.0	7.1	8.0	4.0		19	18.0	20.1	21.0	10.0	
7	6.0	8.1	9.0	4.0		20	19.0	21.1	22.0	10.0	
8	7.0	9.1	10.0	4.0	6.0	21	20.0	22.1	23.0	10.0	10.0
9	8.0	10.1	11.0	4.0		22	21.0	23.1	24.0	10.0	
10	9.0	11.1	12.0	4.0		23	22.0	24.1	25.0	10.0	
11	10.0	12.1	13.0	4.0		24	23.0	25.1	26.0	10.0	
12	11.0	13.1	14.0	4.0		25	24.0	26.1	27.0	10.0	
13	12.0	14.1	15.0	10.0		26	25.0	27.1	28.0	10.0	
14	13.0	15.1	16.0	10.0		27	26.0	28.1	29.0	10.0	
15	14.0	16.1	17.0	10.0		28	27.0	29.1	30.0	10.0	

<b>QUALITY SYMBOLS</b> MAJOR Ⓜ CRITICAL Ⓢ <b>GENERAL TOLERANCES (UNLESS SPECIFIED)</b> X ±0.5 .X ±0.25 .XX ±0.15 .XXX ±0.1 ANGLES ±2°	DRAWN BY Zhu, Wei DATE 18/10/12	
	CHECKED BY Xu, Zhi Yong DATE 18/10/12	
	APPROVED BY Xu, Zhi Yong DATE 18/10/12	SIZE A4 DWG NO. 50661-XXXXX-XXX
	UNITS mm SCALE 5:1	SHEET NO. 1 OF 1 REV B PART NO. SEE NOTES